



1672 Donlon Street
Ventura, CA 93003
Local 805 654-6977
Fax 805 654-6979
www.jdscivil.com

VPD01.4558
Monday, March 18, 2024

To Whom it May Concern,

Attention to bidders of Ventura Harbor Public Boat Wash Station Replacement Project 1400 Anchors Way Dr., Ventura, California. Note, this is the third addendum for the rebid.

Addendum No.3: Project Schedule and Plan Revision

Project Schedule:

Request For Information Requests Due: Thursday, March 21, 2024 @ 4:00 PM
Emailed to: jmccoskey@jdscivil.com, tmitchell@venturaharbor.com,
justin@castleandgray.com & jgonzalez@venturaharbor.com
RFI Responses: Friday, March 22, 2024 in an addendum from CyberCopy.
Bid Due: Tuesday, March 26, 2024 @ 1:00 PM (unchanged)
Bid Opening: March 26, 2024 @ 1:00 PM (unchanged)
Anticipated Notice to Proceed: April 10, 2024
Project Completion: Tuesday, July 2, 2024.

Plan Revisions:

- Added wash down box specifications and extra parts required.
- Revised pedestrian access from brick promenade to the west.
- Added truncated domes along access to the boat ramp.

Previous Addendums:

- No. 1: 3/5/2024 - Answers to pre-bid meeting questions, design changes and bidding procedures
- No. 2: 3/11/2024 – Contractor license type to be A or B.

Thank you for attending the pre-bid meeting and acknowledging this addendum. Remember to acknowledge the first two addendums. We look forward to you bids.

James C. McCoskey, P.E.
Senior Civil Engineer
Jensen Design & Survey, Inc.

K:\VPD14558\Construction Management\2023 Boat Wash\Addendums\4558 Boat Wash Rebid Addendum No 3.doc

ENGINEERS

PLANNERS

SURVEYORS

CONSTRUCTION MANAGERS

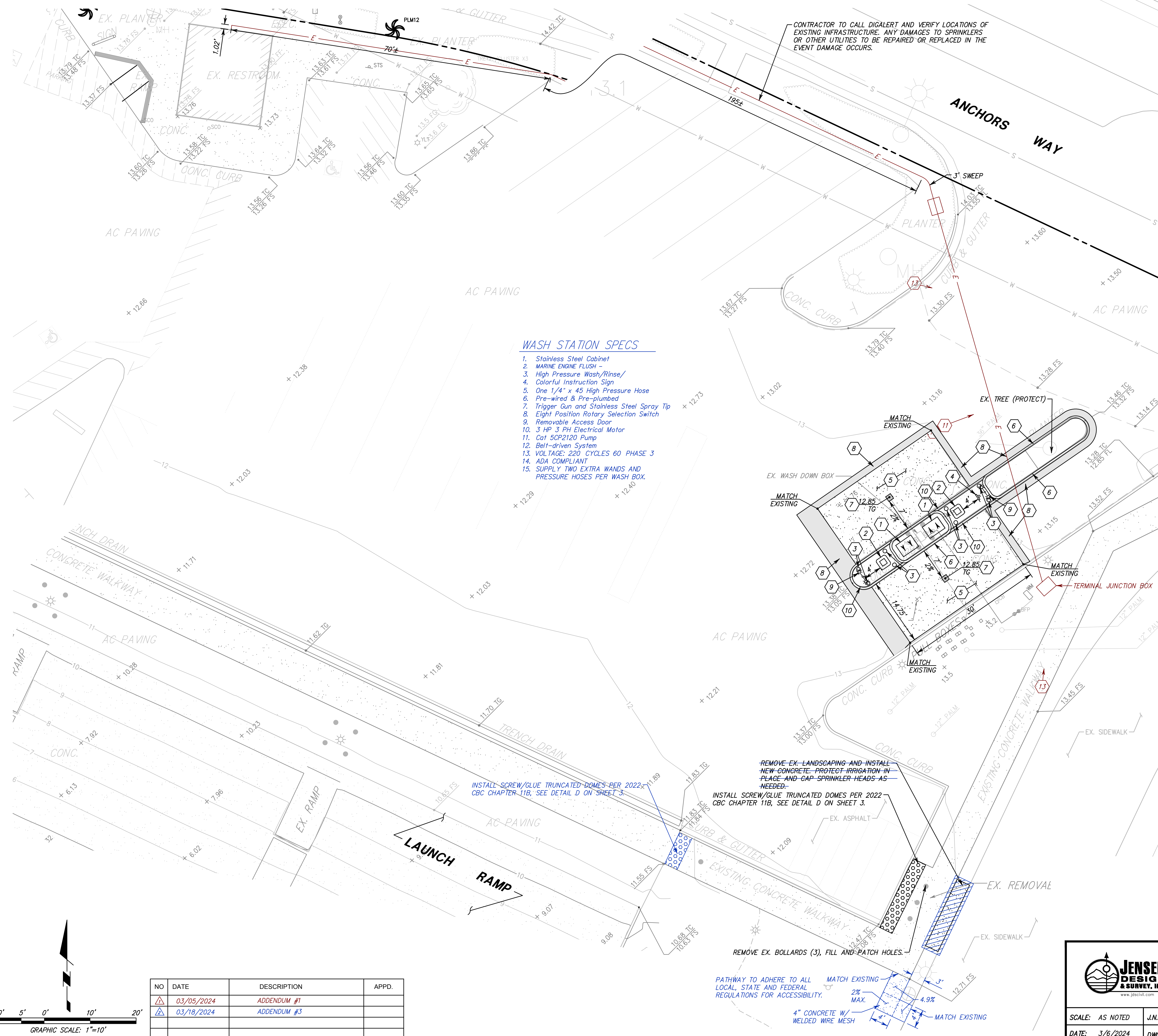

WASH STATION SPECS

1. Stainless Steel Cabinet
2. MARINE ENGINE FLUSH -
3. High Pressure Wash/Rinse/
4. Colorful Instruction Sign
5. One 1/4" x 45 High Pressure Hose
6. Pre-wired & Pre-plumbed
7. Trigger Gun and Stainless Steel Spray Tip
8. Eight Position Rotary Selection Switch
9. Removable Access Door
10. 3 HP 3 PH Electrical Motor
11. Cat SCP2120 Pump
12. Belt-driven System
13. VOLTAGE: 220 CYCLES 60 PHASE 3
14. ADA COMPLIANT
15. SUPPLY TWO EXTRA WANDS AND PRESSURE HOSES PER WASH BOX.

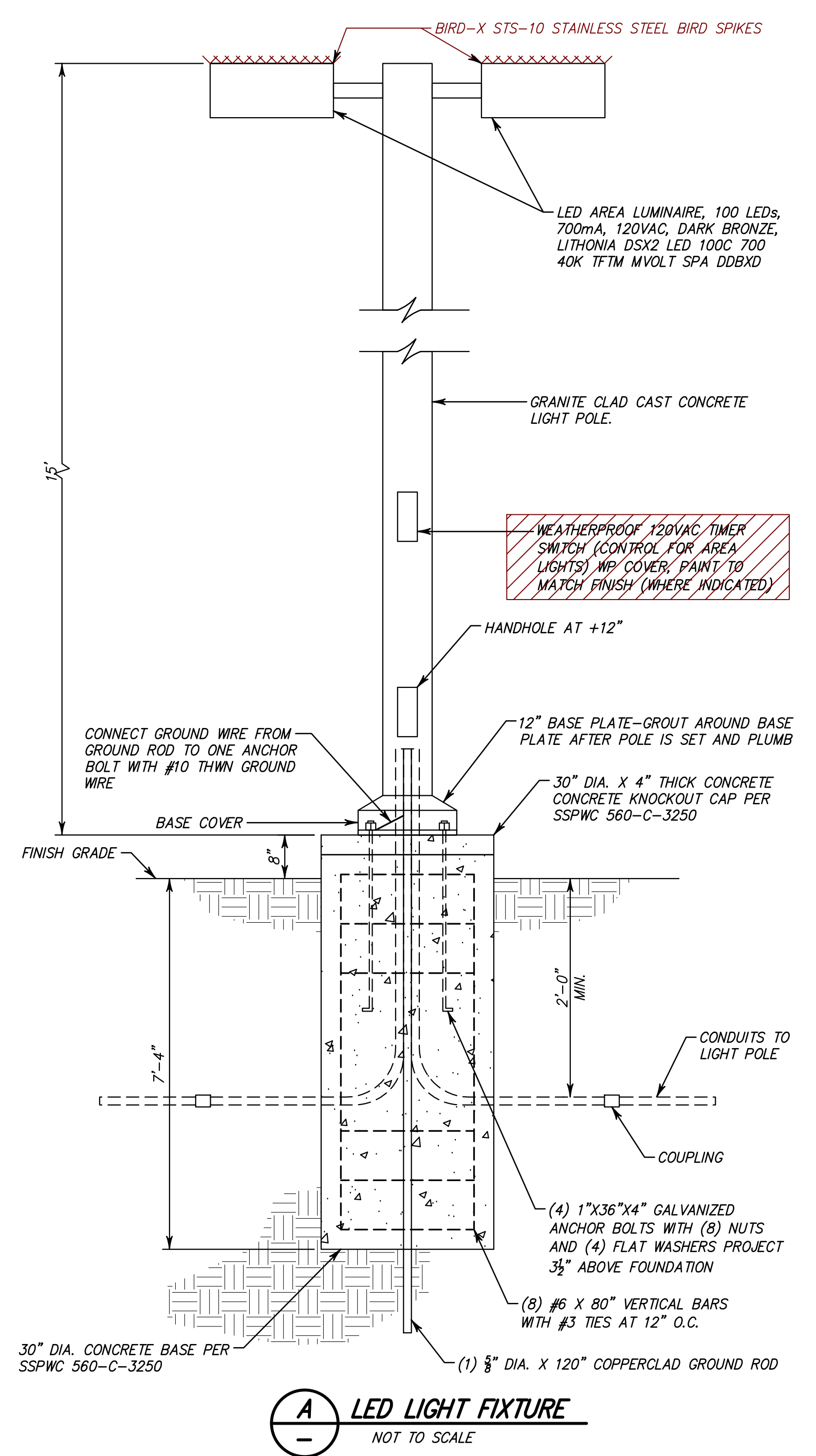

A LED LIGHT FIXTURE
NOT TO SCALE

CONSTRUCTION NOTES

1. COLEMAN HANNA, COIN-OP SPLASH-N-DASH MODEL No. 77560 PER SPECIFICATIONS TO THE LEFT. CONNECT TO EXISTING WATER SERVICE.
2. 53 GALLON SQUARE PORT CONCRETE TRASH CAN WITH 12"x12" VENTURA PORT DISTRICT LOGO. LOGO PROVIDED BY DISTRICT.
3. INSTALL STAINLESS STEEL FIXED SECURITY BOLLARD PER DETAIL B, SHEET 3.
4. REINSTALL SALVAGED FISHING LINE RECYCLE CONTAINER AND SIGN.
5. 8" THICK 2,500 PSI CONCRETE WITH #4 BARS @ 13" O.C.E.W. OVER 8" CLASS II AGGREGATE BASE COMPACTED TO 95% RELATIVE DENSITY.
6. 6" CURB ONLY PER CITY OF VENTURA STD. PLATE 107, SEE DETAIL C ON SHEET 3.
7. 18"x18" CATCH BASIN WITH TRAFFIC RATED METAL GRATE WITH 2 SPARE GRATES PER CB. CALIFORNIA APPROVED FULL STAINLESS STEEL TRASH CAPTURE INSERT REQUIRED & INSTALL "DON'T DUMP DRAINS TO OCEAN" PLACARD. CONNECT TO EXISTING DRAIN PIPE(S).
8. PATCH BETWEEN SAWCUT AND NEW CONSTRUCTION WITH 8" (2 X 4" LIFTS) A.C. OVER 8" CLASS II AGGREGATE BASE COMPACTED TO 95% RELATIVE DENSITY.
9. INSTALL DOUBLE HEAD LIGHT POLE PER DETAIL A THIS SHEET.
10. 0" CURB PER CITY OF VENTURA STD. PLATE 107, SEE DETAIL C ON SHEET 3.
11. INSTALL 1.5" ELECTRICAL CONDUIT WITH #8 GAUGE STRANDED WIRE FROM JUNCTION BOX TO SOUTH CLARIFIER.
12. INSTALL A 1.25" EMPTY "COMMUNICATIONS" ELECTRICAL CONDUIT FROM RESTROOM JUNCTION BOX TO JUNCTION BOX AT SOUTH CLARIFIER AND 1" SPARE ELECTRICAL CONDUIT.
13. INSTALL 208V 3 PHASE CIRCUIT W/ TWO BLACK, RED, BLUE, AND WHITE NEUTRAL WIRES AS WELL AS ONE GREEN GROUND. ALL #8 GAUGE 9 WIRES TOTAL

NO	DATE	DESCRIPTION	APPD.
1	03/05/2024	ADDENDUM #1	
2	03/18/2024	ADDENDUM #3	

JENSEN DESIGN & SURVEY, INC.
1672 DONLON STREET
VENTURA, CALIF. 93003
PHONE 805/654-6977
FAX 805/654-6979
www.jdsurvey.com

SCALE: AS NOTED J.N.: VPD1.4558.019
DATE: 3/6/2024 DWG. NAME: 4558 BOAT WASH.dwg

NEW BOAT WASH FOR VENTURA PORT DISTRICT
1404 ANCHORS WAY
City of Ventura
COUNTY OF VENTURA STATE OF CALIFORNIA

SHEET 2 OF 3